

CENTER QUAD JOIST ON WALL BELOW
(WHEN JOISTS RUN PARALLEL W/ WALL)

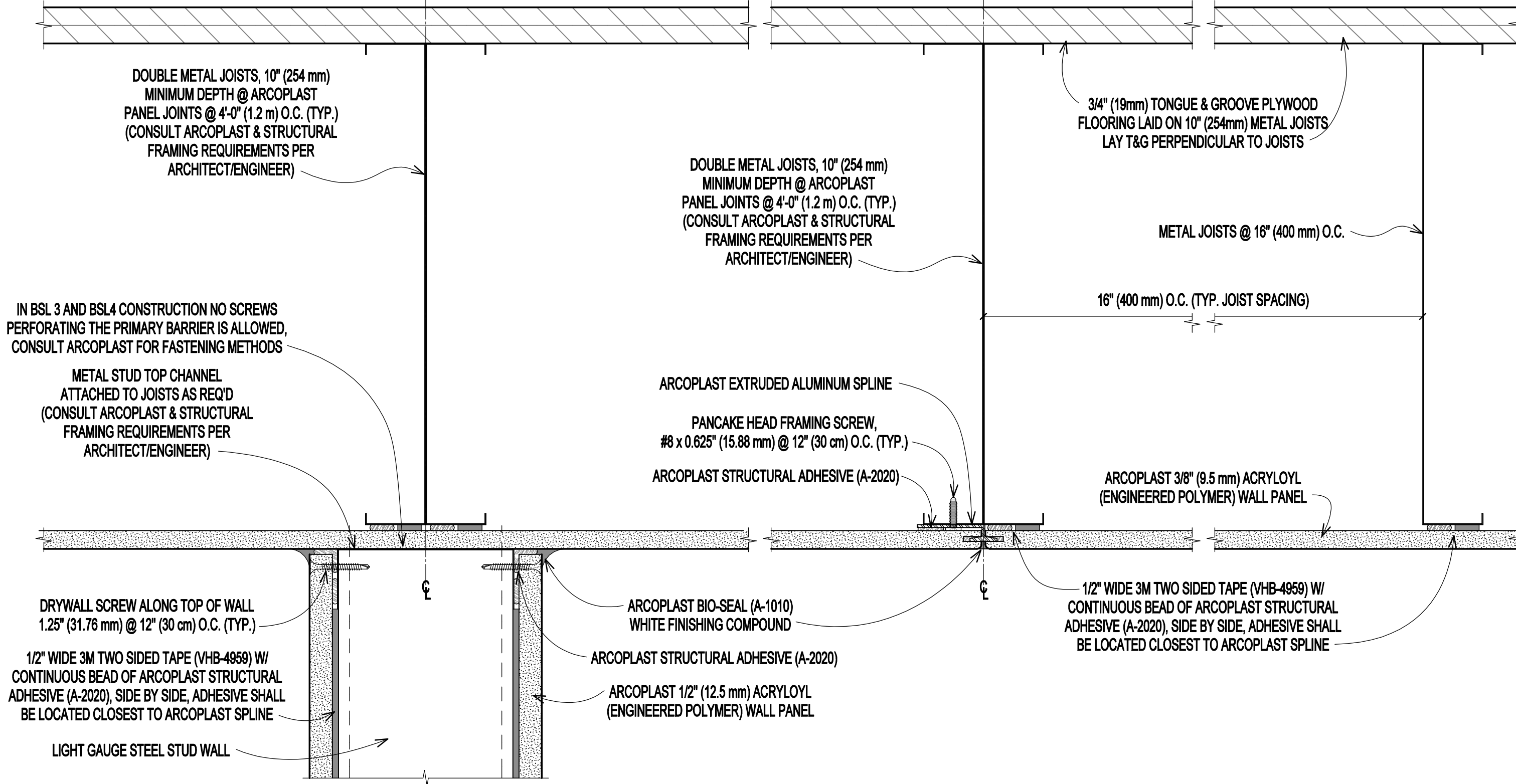

DOUBLE METAL JOISTS, 10" (254 mm)
MINIMUM DEPTH @ ARCOPLAST
PANEL JOINTS @ 4'-0" (1.2 m) O.C. (TYP.)
(CONSULT ARCOPLAST & STRUCTURAL
FRAMING REQUIREMENTS PER
ARCHITECT/ENGINEER)

DOUBLE METAL JOISTS, 10" (254 mm)
MINIMUM DEPTH @ ARCOPLAST
PANEL JOINTS @ 4'-0" (1.2 m) O.C. (TYP.)
(CONSULT ARCOPLAST & STRUCTURAL
FRAMING REQUIREMENTS PER
ARCHITECT/ENGINEER)

3/4" (19mm) TONGUE & GROOVE PLYWOOD
FLOORING LAID ON 10" (254mm) METAL JOISTS
LAY T&G PERPENDICULAR TO JOISTS

METAL JOISTS @ 16" (400 mm) O.C.

16" (400 mm) O.C. (TYP. JOIST SPACING)

IN BSL 3 AND BSL4 CONSTRUCTION NO SCREWS
PERFORATING THE PRIMARY BARRIER IS ALLOWED,
CONSULT ARCOPLAST FOR FASTENING METHODS

METAL STUD TOP CHANNEL
ATTACHED TO JOISTS AS REQ'D
(CONSULT ARCOPLAST & STRUCTURAL
FRAMING REQUIREMENTS PER
ARCHITECT/ENGINEER)

ARCOPLAST EXTRUDED ALUMINUM SPLINE
PANCAKE HEAD FRAMING SCREW,
#8 x 0.625" (15.88 mm) @ 12" (30 cm) O.C. (TYP.)
ARCOPLAST STRUCTURAL ADHESIVE (A-2020)

ARCOPLAST 3/8" (9.5 mm) ACRYLOYL
(ENGINEERED POLYMER) WALL PANEL

DRYWALL SCREW ALONG TOP OF WALL
1.25" (31.76 mm) @ 12" (30 cm) O.C. (TYP.)

ARCOPLAST BIO-SEAL (A-1010)
WHITE FINISHING COMPOUND

1/2" WIDE 3M TWO SIDED TAPE (VHB-4959) W/
CONTINUOUS BEAD OF ARCOPLAST STRUCTURAL
ADHESIVE (A-2020), SIDE BY SIDE, ADHESIVE SHALL
BE LOCATED CLOSEST TO ARCOPLAST SPLINE

1/2" WIDE 3M TWO SIDED TAPE (VHB-4959) W/
CONTINUOUS BEAD OF ARCOPLAST STRUCTURAL
ADHESIVE (A-2020), SIDE BY SIDE, ADHESIVE SHALL
BE LOCATED CLOSEST TO ARCOPLAST SPLINE

ARCOPLAST STRUCTURAL ADHESIVE (A-2020)

ARCOPLAST 1/2" (12.5 mm) ACRYLOYL
(ENGINEERED POLYMER) WALL PANEL

LIGHT GAUGE STEEL STUD WALL

ACRYLOYL (ENGINEERED POLYMER) WALL PANEL, WALL TO CEILING WITH WALK-ON CEILING

DWG # PP-18-EP	SCALE 6" (1:2)
DATE 2/20/2020	CHECKED GB



1873 WILLIAMSTOWN DRIVE
ST. PETERS, MISSOURI USA 63376
T: 888-736-2726 F: 636-978-7782

arcoplast
WALL AND CEILING SYSTEMS

WWW.ARCOPLAST.COM

THE INFORMATION CONTAINED IN THIS DOCUMENT IS PROPRIETARY TO ARCOPLAST. ALL COPYRIGHTS AND OTHER PROPRIETARY RIGHTS APPLICABLE SHALL REMAIN AT ALL TIMES ARCOPLAST'S PROPERTY. DOCUMENTS SHALL NOT BE USED, COPIED OR HARVESTED FROM THE CAD FILE. THE INFORMATION CONTAINED WITHIN WITHOUT THE WRITTEN CONSENT OF ARCOPLAST. DOCUMENTS, DESIGNS, DRAWINGS AND SPECIFICATIONS ARE CONCEPTUAL IN NATURE AND ARE INTENDED TO SET FORTH DESIGN INTENT ONLY AND ARE NOT TO BE USED FOR ENGINEERING PURPOSES.