

THE INFORMATION CONTAINED IN THIS DOCUMENT IS PROPRIETARY TO ARCOPLAST. ALL COPYRIGHTS AND OTHER PROPRIETARY RIGHTS APPLICABLE SHALL REMAIN AT ALL TIMES ARCOPLAST'S PROPERTY. DOCUMENTS SHALL NOT BE USED, COPIED OR HARVESTED FROM THE CAD FILE, THE INFORMATION CONTAINED WITHIN WITHOUT THE WRITTEN CONSENT OF ARCOPLAST. DOCUMENTS, DESIGNS, DRAWINGS AND SPECIFICATIONS ARE CONCEPTUAL IN NATURE AND AND ARE INTENDED TO SET FORTH DESIGN INTENT ONLY AND ARE NOT TO BE USED FOR ENGINEERING PURPOSES.

ABSOLUTELY NO MECHANICAL FASTENERS SHALL PENETRATE LEAD SHIELDED GFRP MODULAR PANEL

METAL STUDS @ 16" (400mm) O.C. (CONSULT ARCOPLAST & STRUCTURAL FRAMING REQUIREMENTS PER ARCHITECT/ENGINEER)

FORM LEAD SHEILD INTO 2" (50.8mm) x 2" (50.8mm) ANGLE, INSTALL INTO "CORNER" W/ ADHESIVE SEALANT FAST CURE 4000 UV

1/2" WIDE 3M TWO SIDED TAPE (VHB-4956) W/ CONTINUOUS BEAD OF ARCOPLAST STRUCTURAL ADHESIVE (A-2020), SIDE BY SIDE, ADHESIVE SHALL BE LOCATED CLOSEST TO ARCOPLAST SPLINE

CEILING FRAMING @ 16" (400mm) O.C. (CONSULT ARCOPLAST & STRUCTURAL FRAMING REQUIREMENTS PER ARCHITECT/ENGINEER)

1/2" WIDE 3M TWO SIDED TAPE (VHB-4959) W/ CONTINUOUS BEAD OF ARCOPLAST STRUCTURAL ADHESIVE (A-2020), SIDE BY SIDE, ADHESIVE SHALL BE LOCATED CLOSEST TO CEILING EDGE

ARCOPLAST 1/2" (12.5mm) LEAD SHIELDED GFRP MODULAR PANEL

ARCOPLAST BIO-SEAL (A-1010) WHITE FINISHING COMPOUND

PRE-FILL WITH ARCOPLAST STRUCTURAL ADHESIVE (A-2020)

ARCOPLAST 1/2" (12.5mm) LEAD SHIELDED GFRP MODULAR PANEL

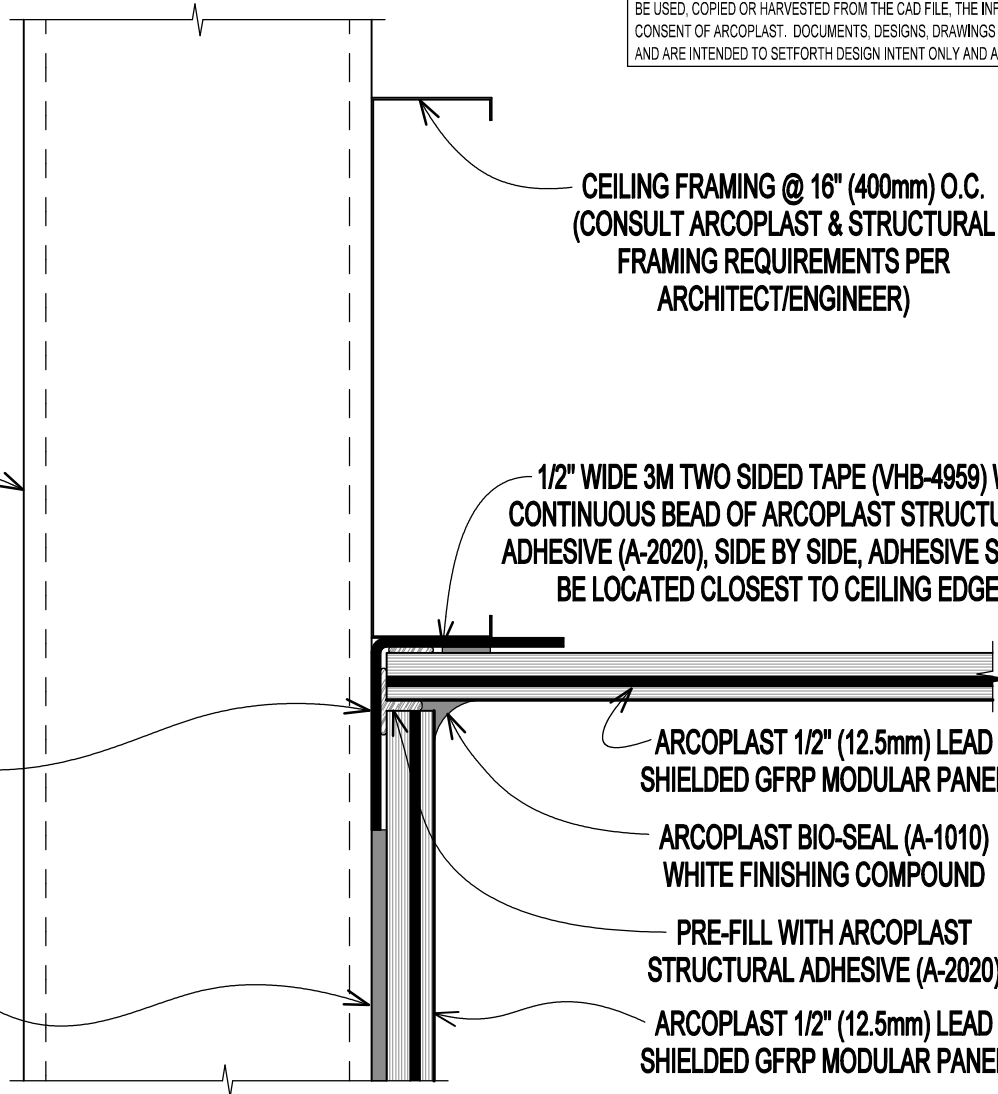

LEAD SHIELDED GFRP WALL PANEL, WALL TO CEILING

DWG # PP-12	SCALE 6" (1:2)
DATE 2/20/2020	CHECKED GB

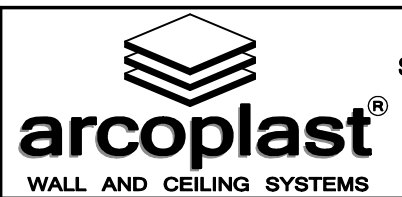

1873 WILLIAMSTOWN DRIVE
ST. PETERS, MISSOURI USA 63376
T: 888-736-2726 F: 636-978-7782
WWW.ARCOPLAST.COM