

THE INFORMATION CONTAINED IN THIS DOCUMENT IS PROPRIETARY TO ARCOPLAST. ALL COPYRIGHTS AND OTHER PROPRIETARY RIGHTS APPLICABLE SHALL REMAIN AT ALL TIMES ARCOPLAST'S PROPERTY. DOCUMENTS SHALL NOT BE USED, COPIED OR HARVESTED FROM THE CAD FILE. THE INFORMATION CONTAINED WITHIN WITHOUT THE WRITTEN CONSENT OF ARCOPLAST. DOCUMENTS, DESIGNS, DRAWINGS AND SPECIFICATIONS ARE CONCEPTUAL IN NATURE AND AND ARE INTENDED TO SET FORTH DESIGN INTENT ONLY AND ARE NOT TO BE USED FOR ENGINEERING PURPOSES.

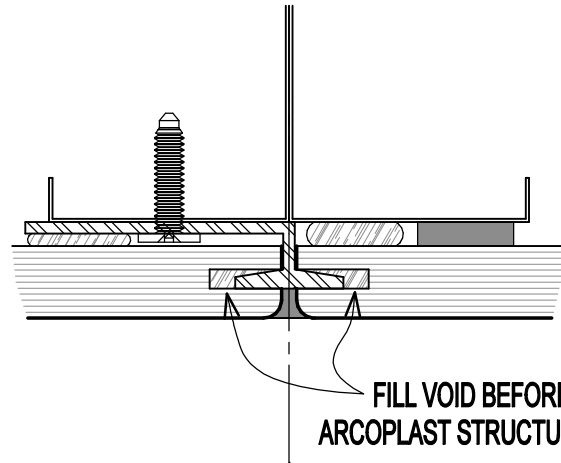

DOUBLE METAL STUDS @ ARCOPLAST
PANEL JOINTS @ 4'-0" (1.2 m) O.C. (TYP.)
(CONSULT ARCOPLAST & STRUCTURAL
FRAMING REQUIREMENTS PER
ARCHITECT/ENGINEER)

PANCAKE HEAD FRAMING SCREW,
#8 x 0.625" (15.88 mm) @ 12" (30 cm) O.C. (TYP.)
ARCOPLAST STRUCTURAL ADHESIVE (A-2020)

METAL STUDS @ 16" (400 mm) O.C.

16" (400 mm) O.C. (TYP. STUD SPACING)

ARCOPLAST 3/8" (9.5 mm) GFRP
MODULAR WALL PANEL

ARCOPLAST EXTRUDED ALUMINUM SPLINE
ARCOPLAST BIO-SEAL (A-1010)
WHITE FINISHING COMPOUND

1/2" WIDE 3M TWO SIDED TAPE (VHB-4959) W/
CONTINUOUS BEAD OF ARCOPLAST STRUCTURAL
ADHESIVE (A-2020), SIDE BY SIDE, ADHESIVE SHALL
BE LOCATED CLOSEST TO ARCOPLAST SPLINE

GFRP WALL PANEL SPLINE ASSEMBLY

DWG #
PP-1

SCALE
6" (1:2)

DATE
2/20/2020

CHECKED
GB



1873 WILLIAMSTOWN DRIVE
ST. PETERS, MISSOURI USA 63376
T: 888-736-2726 F: 636-978-7782

WWW.ARCOPLAST.COM